

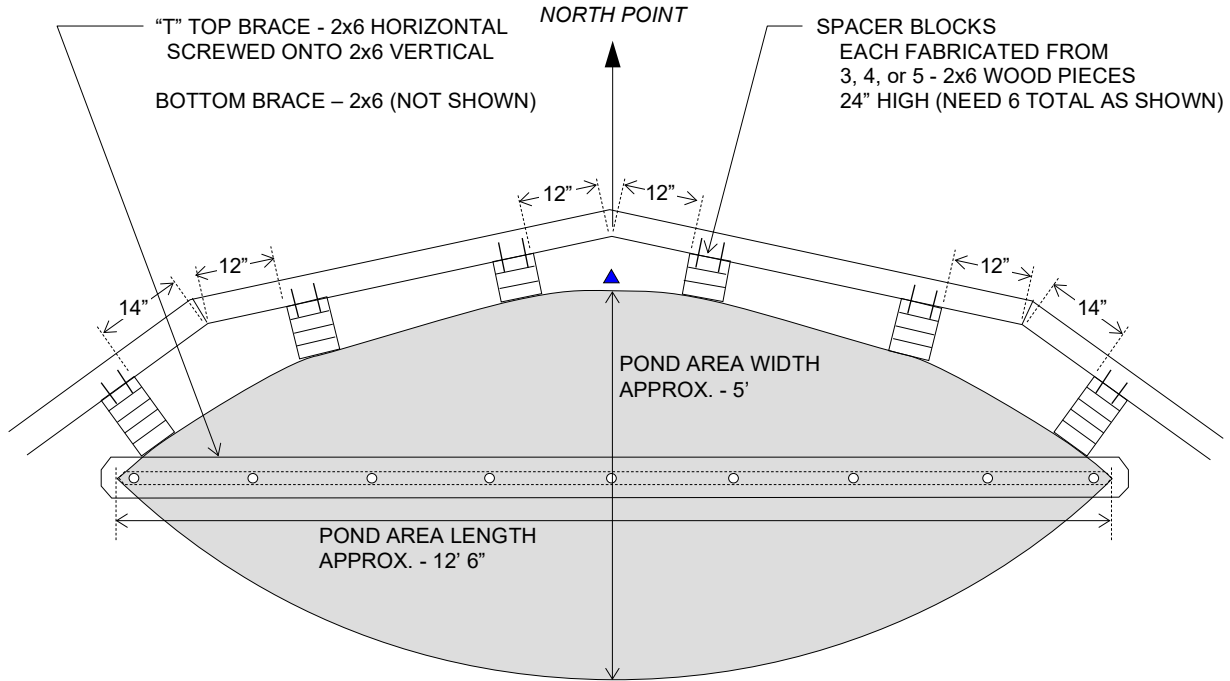

# 26' GROWING DOME POND FABRICATION Step 1

## OVAL ABOVE GROUND POND LAYOUT

ACTUAL LENGTH OF POND METAL WALLS – 13' 9" L x 4' H



The six spacer blocks can be mounted prior to digging out the area for the pond per the measurements above. The blocks consist of 3, 4, or 5 - 2x6 by 24" pieces of lumber (as shown above) (provided with kit) that are married together in place using the screw pattern shown below.

### LAYOUT INSTRUCTIONS:

From the north point (indicated by the blue triangle above), go 6' 10-1/2" (one half the actual length of the pond metal) east and west following the contour of the spacer blocks. This will represent the back pond metal piece. Mark these 2 points as the pond metal corners. Go back to the blue triangle. From there come out directly south 5' and mark that point which represents the width of the pond at its widest. Connect a second 13' 9" line (actual length of the pond metal) to both pond corners creating a smooth arc connecting all three points. This represents the front pond metal piece. This will give you a fairly accurate layout of where the pond will go.

## SCREW PATTERN FOR FABRICATED SPACER BLOCKS

**FABRICATED SPACER BLOCKS:** (4-3" Deck Screws per each 2x6) (Total 96 + 5 Screws)  
(2 @ 3 Boards per Block / 2 @ 4 Boards per Block / 2 @ 5 Boards per Block) (6 Blocks Total)

Pre-drill all screw holes 3/4" down from top, 3/4" up from bottom and 3/4" in from each side for the 1<sup>st</sup> board of each spacer block.

Then pre-drill all subsequent screw holes in the patterns as shown to the right.

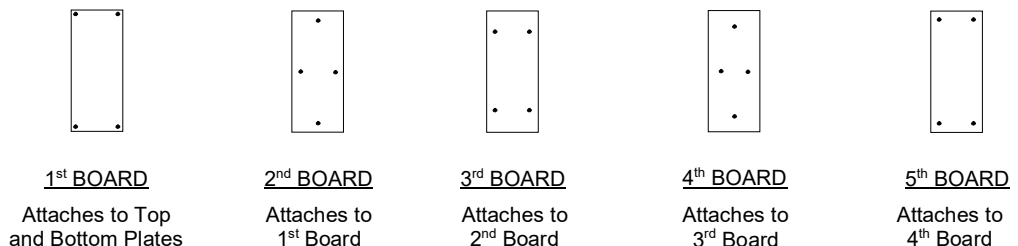

NOTICE: Screws are offset on 2<sup>nd</sup>, 3<sup>rd</sup>, 4<sup>th</sup>, and 5<sup>th</sup> Boards so as to miss the screws underneath and also the 2" lag screws that attaches the pond back metal to these spacer blocks.